





Rose Walk Cottages  
Upper Oddington **GL56**

---

# A unique opportunity to acquire a quartet of very successful holiday cottages in the heart of this sought after village

			EPC	EPC	EPC	EPC
5	5	5	F	F	E	F

## Summary of accommodation

**1 Rose Walk Cottages** Open plan living room with fireplace and fitted kitchen  
Double bedroom with en suite | Garden and parking

**2 Rose Walk Cottages** Kitchen breakfast room with fitted units  
Sitting room with fireplace | Two double bedrooms | One en suite shower room and a bathroom | Garden and parking

**3 Rose Walk Cottages** Entrance porch | Open plan living room with fireplace and fitted kitchen | Double bedroom with en suite bathroom  
Garden and parking

**4 Rose Walk Cottages** Entrance porch | Open plan living room with fireplace and fitted kitchen | Double bedroom with en suite bathroom  
Garden and parking

**Distances** Stow-on-the-Wold 3 miles, Kingham (trains to London Paddington from 76 mins) 3 miles, Chipping Norton 6 miles, Cheltenham 23 miles, Oxford 26 miles (All times and distances are approximate)





## Location

Upper Oddington is a particularly attractive village located in an area renowned as one of outstanding natural beauty. Amenities within the village include a church, and two well-regarded public houses, The Fox Inn and The Horse and Groom. The renowned Daylesford Organic Farm Shop is just a mile and a half away, with further shopping facilities being found in the nearby market towns of Stow-on-the-Wold and Chipping Norton.

More comprehensive facilities can be found in Cheltenham, Stratford-upon-Avon, Oxford and Banbury. A number of similarly well regarded villages can be found nearby with the likes of Kingham with its two pubs and village shop, Bledington with the popular Kings Head Inn and village shop and Churchill with the Chequers Inn.

Sporting facilities in the area include racing at Cheltenham and Stratford-upon-Avon, golf courses at Lyneham, Naunton Downs and Burford, rugby at Worcester and Gloucester.

A number of public footpaths and bridleways offer the opportunity to take in the glorious countryside scenery.



## Property

Rose Walk Cottages provide a terrace of four individual cottages which are currently run as a very successful holiday letting business. These beautiful Cotswold stone cottages are perfectly located in the heart of the village to access all that the North Cotswolds has to offer.

Cottages 1, 3 and 4 each provide an open plan living space on the ground floor with fitted shaker style kitchen units complete with Aga, dining space and a cosy area in front of the fireplace which benefits from a wood burning stove. Stairs lead to a landing on the first floors, each with a double bedroom and en suite. Cottages 3 and 4 also have the benefit of a recent front porch extensions.

Cottage 2 is the largest of the cottages with a generous kitchen breakfast room on the ground floor with a range of fitted units and Aga, and a well-proportioned sitting room with fireplace and wood burning stove. Two double bedrooms are on hand on the first floor, one with en suite shower room plus a family bathroom.

Outside, each of the cottages have their own private terrace with a larger lawned area beyond. Parking is on hand to provide a space for each of the cottages.





## Outside

Outside, each of the cottages have their own private terrace with a larger lawned area beyond. Parking is on hand to provide a space for each of the cottages.

## Services

Mains water, drainage and electricity.

## Tenure

Freehold

## Local Authority

Cotswold District Council 01285 623000

## Directions

Leave Stow-on-the-Wold on the A436 towards Chipping Norton. After almost 2 miles take the first right hand turning signposted to Oddington. Proceed down the hill and take the first right hand turning into Back Lane, the driveway for the cottages will be found after approximately 150m on the left hand side.

### Approximate Gross Internal Floor Area

Cottage 1: 42.6 sq m (459 sq ft)

Cottage 2: 83.6 sq m (901 sq ft)

Cottage 3: 42 sq m (452 sq ft)

Cottage 4: 42 sq m (452 sq ft)

Total: 210.2 sq m (2,264 sq ft)

This plan is for guidance only and must not be relied upon as a statement of fact. Attention is drawn to the important notice on the last page of the text of the Particulars.

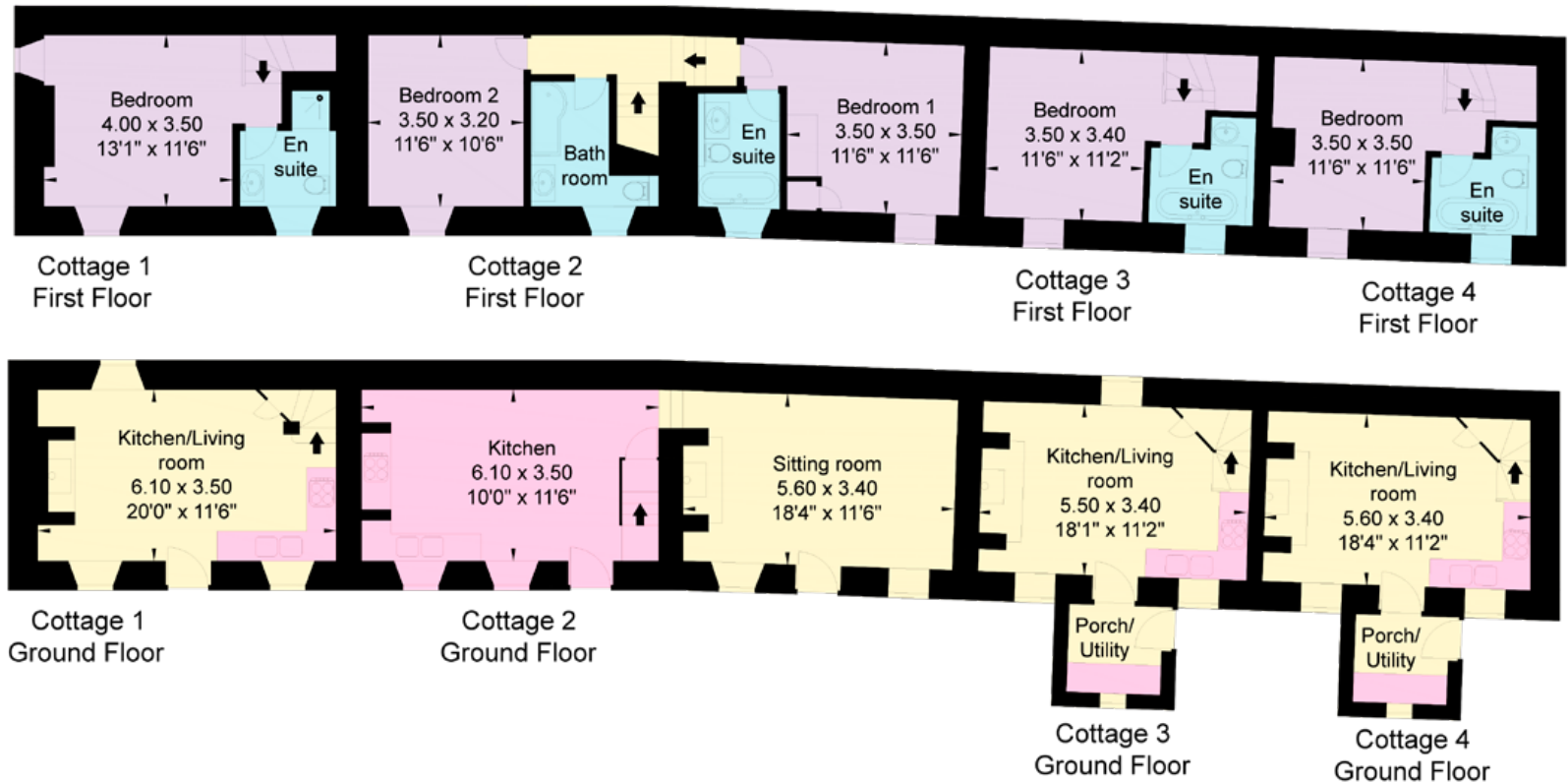

Knight Frank Stow-on-the-Wold  
Brett House, Park Street  
Stow-on-the-Wold  
GL54 1AG  
[knightfrank.co.uk](https://www.knightfrank.co.uk)

I would be delighted to tell you more

Leigh Glazebrook  
01451 600610  
[Leigh.Glazebrook@knightfrank.com](mailto:Leigh.Glazebrook@knightfrank.com)



Fixtures and fittings: A list of the fitted carpets, curtains, light fittings and other items fixed to the property which are included in the sale (or may be available by separate negotiation) will be provided by the Seller's Solicitors. Important Notice: 1. Particulars: These particulars are not an offer or contract, nor part of one. You should not rely on statements by Knight Frank LLP in the particulars or by word of mouth or in writing ("information") as being factually accurate about the property, its condition or its value. Neither Knight Frank LLP nor any joint agent has any authority to make any representations about the property, and accordingly any information given is entirely without responsibility on the part of the agents, seller(s) or lessor(s). 2. Photos, Videos etc: The photographs, property videos and virtual viewings etc. show only certain parts of the property as they appeared at the time they were taken. Areas, measurements and distances given are approximate only. 3. Regulations etc: Any reference to alterations to, or use of, any part of the property does not mean that any necessary planning, building regulations or other consent has been obtained. A buyer or lessee must find out by inspection or in other ways that these matters have been properly dealt with and that all information is correct. 4. VAT: The VAT position relating to the property may change without notice. 5. To find out how we process Personal Data, please refer to our Group Privacy Statement and other notices at <https://www.knightfrank.com/legal/privacy-statement>. Particulars dated September 2021. Photographs and videos dated August 2016.

Knight Frank is the trading name of Knight Frank LLP. Knight Frank LLP is a limited liability partnership registered in England and Wales with registered number OC305934. Our registered office is at 55 Baker Street, London W1U 8AN where you may look at a list of members' names. If we use the term 'partner' when referring to one of our representatives, that person will either be a member, employee, worker or consultant of Knight Frank LLP and not a partner in a partnership. If you do not want us to contact you further about our services then please contact us by either calling 020 3544 0692, email to [marketing.help@knightfrank.com](mailto:marketing.help@knightfrank.com) or post to our UK Residential Marketing Manager at our registered office (above) providing your name and address.