



Whitehall Court, St James's **SWIA**

---

# Whitehall Court

## St James's SW1A

The property is blessed with some of the best views in London,. One side looks over St James's Park, and the other side looks over the River Thames and the London Eye. There are two large bedrooms, three bathrooms, two amazing reception rooms boasting 7m ceiling heights in parts, a study, a turret room, and an amazing roof terrace looking out over Whitehall and St James's Park.

•We have been unable to obtain the ground rent review period. You will need to make your own enquiries.



**Guide price:** £4,500,000

**Tenure:** Leasehold: approximately 63 years remaining

**Ground rent:** £200 per annum

**Local authority:** City of Westminster

**Council tax band:** H

## Location

Located on Embankment, just south of Trafalgar Square and opposite the landmark London Eye on the river, Whitehall Court benefits from outstanding local transport links, with easy access to neighbouring Mayfair and Covent Garden and quick links to the City and Canary Wharf.

The property is perfectly placed for the many attractions of the West End, including The Royal Opera House, Theatres, The National Portrait Gallery, the Covent Garden Piazza and the Southbank Arts Centre for the Royal Festival Hall and the National Theatre.

Adjacent to Whitehall Court is the 5\* Corinthia Hotel with luxury facilities including the ESPA spa and pool. St James's Park is a 5 minute walk, leading to Green Park and Hyde Park.









## Whitehall Court, SW1A

Approximate Floor Area = 256.6 sq m / 2762 sq ft  
Including Limited Use Area (27.8 sq m / 299 sq ft)  
(Excluding Void)

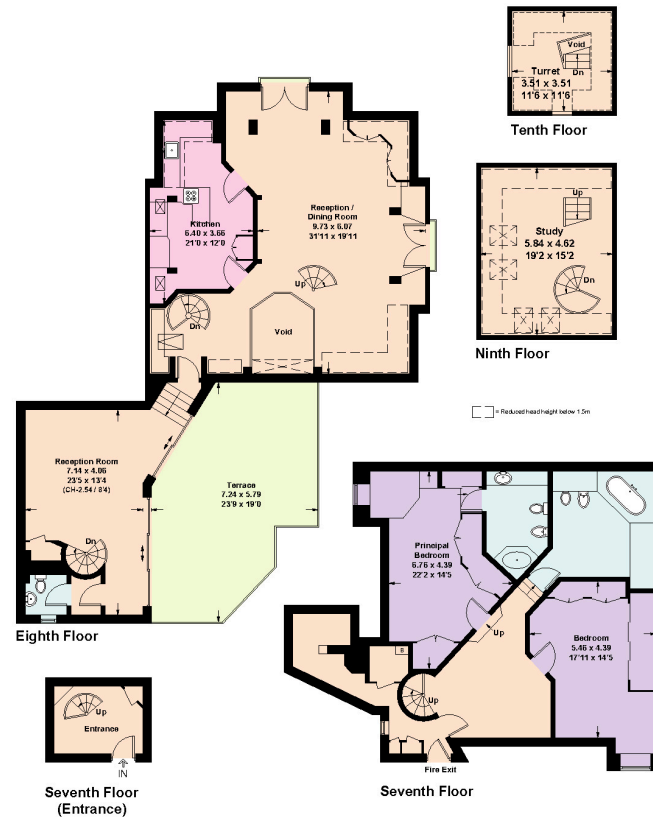

This plan is for layout guidance only. Not drawn to scale unless stated. Windows and door openings are approximate. Whilst every care is taken in the preparation of this plan, please check all dimensions, shapes and compass bearings before making any decisions reliant upon them. (ID936432)

**Knight Frank**

**Mayfair**

120a Mount Street

London

W1K 3NN

[knightfrank.co.uk](http://knightfrank.co.uk)

I would be delighted to tell you more

**Jonathan Fieldman**

020 7647 6615

[jonathan.fieldman@knightfrank.com](mailto:jonathan.fieldman@knightfrank.com)



Fixtures and fittings: A list of the fitted carpets, curtains, light fittings and other items fixed to the property which are included in the sale (or may be available by separate negotiation) will be provided by the Seller's Solicitors.

Important Notice: 1. Particulars: These particulars are not an offer or contract, nor part of one. You should not rely on statements by Knight Frank LLP or by word of mouth or in writing ("information") as being factually accurate about the property, its condition or its value. Neither Knight Frank LLP nor any joint agent has any authority to make any representations about the property, and accordingly any information given is entirely without responsibility on the part of the agents, seller(s) or lessor(s). 2. Photos, Videos etc: The photographs, property videos and virtual viewings etc. show only certain parts of the property as they appeared at the time they were taken. Areas, measurements and distances given are approximate only. 3. Regulations etc: Any reference to alterations to, or use of, any part of the property does not mean that any necessary planning, building regulations or other consent has been obtained. A buyer or lessee must find out by inspection or in other ways that these matters have been properly dealt with and that all information is correct. 4. VAT: The VAT position relating to the property may change without notice. 5. To find out how we process Personal Data, please refer to our Group Privacy Statement and other notices at <https://www.knightfrank.com/legals/privacy-statement>.

Particulars dated February 2023. Photographs and videos dated February 2023.

Knight Frank is the trading name of Knight Frank LLP. Knight Frank LLP is a limited liability partnership registered in England and Wales with registered number OC305934. Our registered office is at 55 Baker Street, London W1U 8AN where you may look at a list of members' names. If we use the term 'partner' when referring to one of our representatives, that person will either be a member, employee, worker or consultant of Knight Frank LLP and not a partner in a partnership. If you do not want us to contact you further about our services then please contact us by either calling 020 3544 0692, email to [marketing.help@knightfrank.com](mailto:marketing.help@knightfrank.com) or post to our UK Residential Marketing Manager at our registered office (above) providing your name and address.