



Beam Cottage, Houghton, Nr Stockbridge

---

# Beam Cottage, Houghton, Hampshire

---

Grade II listed Beam Cottage is thought to date from the 17th century when we understand it was once three separate cottages. In 2010 the cottage was extended with the addition of the hall, utility, workshop, studio and double garage.

A spacious and modern hall leads to the enormously characterful main house with its lovely exposed beams and brick work. The high quality kitchen has an Aga, marble work tops and a superb two drawer dishwasher. The cosy snug and dining room are adjacent. There is also a study and garden room. Separate staircases lead to the principal bedroom with an en suite and two other bedrooms and bathroom. Above the garage is the large studio/office room which might also be used as a fourth bedroom.

The house is situated in the village conservation area and approached via a five bar gate over a shingle drive. There is plenty of space to the front of the property for parking and there is a generous double garage. To the rear of the house are patio areas and lawn which can be accessed from the garden room. The garden is enclosed by fencing and hedging and there is a good working garden area with shed. The workshop is accessed from the garden. The double garage has electric doors opening on to the drive.



3-4



2



3-4

EPC

D



Local Authority: Test Valley Borough Council  
Council Tax band: G  
Tenure: Available freehold

Guide price  
**£975,000**

**Beam Cottage**  
Approximate Gross Internal Area  
Main House = 2566 Sq Ft / 238.33 Sq M  
Garage = 334 Sq Ft / 31.06 Sq M  
Total = 2900 Sq Ft / 269.39 Sq M  
includes areas with Restricted room height.



FIRST FLOOR



FIRST FLOOR

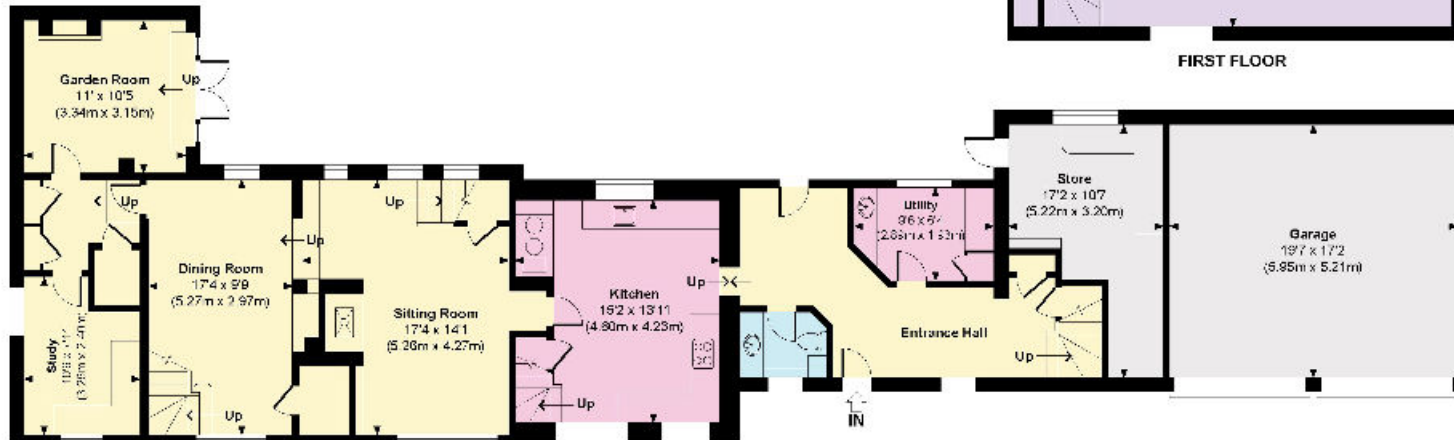

GROUND FLOOR

Knight Frank  
Winchester  
14-15 Jewry Street  
Winchester  
SO23 8RZ  
[knightfrank.co.uk](http://knightfrank.co.uk)

I would be delighted to tell you more  
Ed Hunt  
01962 677236  
[edward.hunt@knightfrank.com](mailto:edward.hunt@knightfrank.com)



Fixtures and fittings: A list of the fitted carpets, curtains, light fittings and other items fixed to the property which are included in the sale (or may be available by separate negotiation) will be provided by the Seller's Solicitors.

Important Notice: 1. Particulars: These particulars are not an offer or contract, nor part of one. You should not rely on statements by Knight Frank LLP in the particulars or by word of mouth or in writing ("information") as being factually accurate about the property, its condition or its value. Neither Knight Frank LLP nor any joint agent has any authority to make any representations about the property, and accordingly any information given is entirely without responsibility on the part of the agents, seller(s) or lessor(s). 2. Photos, Videos etc: The photographs, property videos and virtual viewings etc. show only certain parts of the property as they appeared at the time they were taken. Areas, measurements and distances given are approximate only. 3. Regulations etc: Any reference to alterations to, or use of, any part of the property does not mean that any necessary planning, building regulations or other consent has been obtained. A buyer or lessee must find out by inspection or in other ways that these matters have been properly dealt with and that all information is correct. 4. VAT: The VAT position relating to the property may change without notice. 5. To find out how we process Personal Data, please refer to our Group Privacy Statement and other notices at <https://www.knightfrank.com/legals/privacy-statement>.

Particulars dated September 2023. Photographs and videos dated September 2023.

All information is correct at the time of going to print. Knight Frank is the trading name of Knight Frank LLP. Knight Frank LLP is a limited liability partnership registered in England and Wales with registered number OC305934. Our registered office is at 55 Baker Street, London W1U 8AN. We use the term 'partner' to refer to a member of Knight Frank LLP, or an employee or consultant. A list of members names of Knight Frank LLP may be inspected at our registered office. If you do not want us to contact you further about our services then please contact us by either calling 020 3544 0692, email to [marketing.help@knightfrank.com](mailto:marketing.help@knightfrank.com) or post to our UK Residential Marketing Manager at our registered office (above) providing your name and address.