



Constance Close, London **SW15**

---



## Property

Meticulously designed by the current owners in collaboration with renowned Hugh Strange Architects, this exceptional property seamlessly combines contemporary comfort with timeless elegance. Clad in beautiful Western Red Cedar, the home features four spacious bedrooms, luxury bathrooms and open plan living on the ground floor.

Extensive insulation, reconstructed walls and floors, an Air Source Heat Pump (ASHP), and underfloor heating throughout ensure optimal comfort and energy efficiency, further enhanced by solar panels on the roof.

The ground floor of this remarkable home offers a modern kitchen that opens into a spacious living room with an open-plan layout and serene views of the large walled garden. Benefitting from exceptional levels of light this floor also includes a comfortable bedroom.

The lower ground floor features a large bedroom, two utility rooms, a studio, and a bathroom. The first floor has another good-sized bedroom with a large bathroom, while the second floor offers a fourth bedroom in the tower with stunning panoramic views.

The property is further enhanced by a grand staircase blending style with practicality as well as two garage spaces.

Planning is approved for the construction of an additional three storey rear extension. Further information and related drawings or to arrange a private consultation, please enquire for further details.

At the end of the expansive 40-metre garden, a newly built garden room offers a peaceful retreat, perfectly positioned next to Richmond Park. Additional features include a separate garden office and a double garage, providing versatile spaces for work and relaxation. This property is the perfect blend of luxury, sustainability, and functionality in an enviable setting.







## Location

Situated in the highly sought-after area of SW15, North Dorincourt enjoys a prime location on Constance Close, offering a serene and private setting while remaining conveniently close to the vibrant amenities of Putney and Richmond.

Nestled alongside the vast expanse of Richmond Park, this location provides direct access to beautiful green spaces and outdoor pursuits, nearby all of London's finest schools, shops, and dining options. Excellent transport links, including nearby train and bus services, ensure seamless connections to Central London and beyond, making this the perfect balance of tranquillity and city living.

**Guide Price: £1,900,000**

**Tenure: Freehold**

**Local Authority: London Borough of Kingston Upon Thames**

**Council Tax Band: G**

**EPC: E**











Masterfully designed four bedroom residence blending contemporary luxury with sustainable living, set beside Richmond Park with expansive gardens.





# Constance Close, SW15

Approximate Gross Internal Area  
 Lower Ground Floor = 70.4 sq m / 758 sq ft  
 Ground Floor = 77.4 sq m / 833 sq ft  
 First Floor = 41.4 sq m / 446 sq ft  
 Second Floor = 12.4 sq m / 133 sq ft  
 Garage = 26.1 sq m / 281 sq ft  
 Garden Office = 15.0 sq m / 161 sq ft  
 Total = 242.7 sq m / 2612 sq ft



This plan is for guidance only and must not be relied upon as a statement of fact. Attention is drawn to the important notice on the last page of the text of the Particulars.

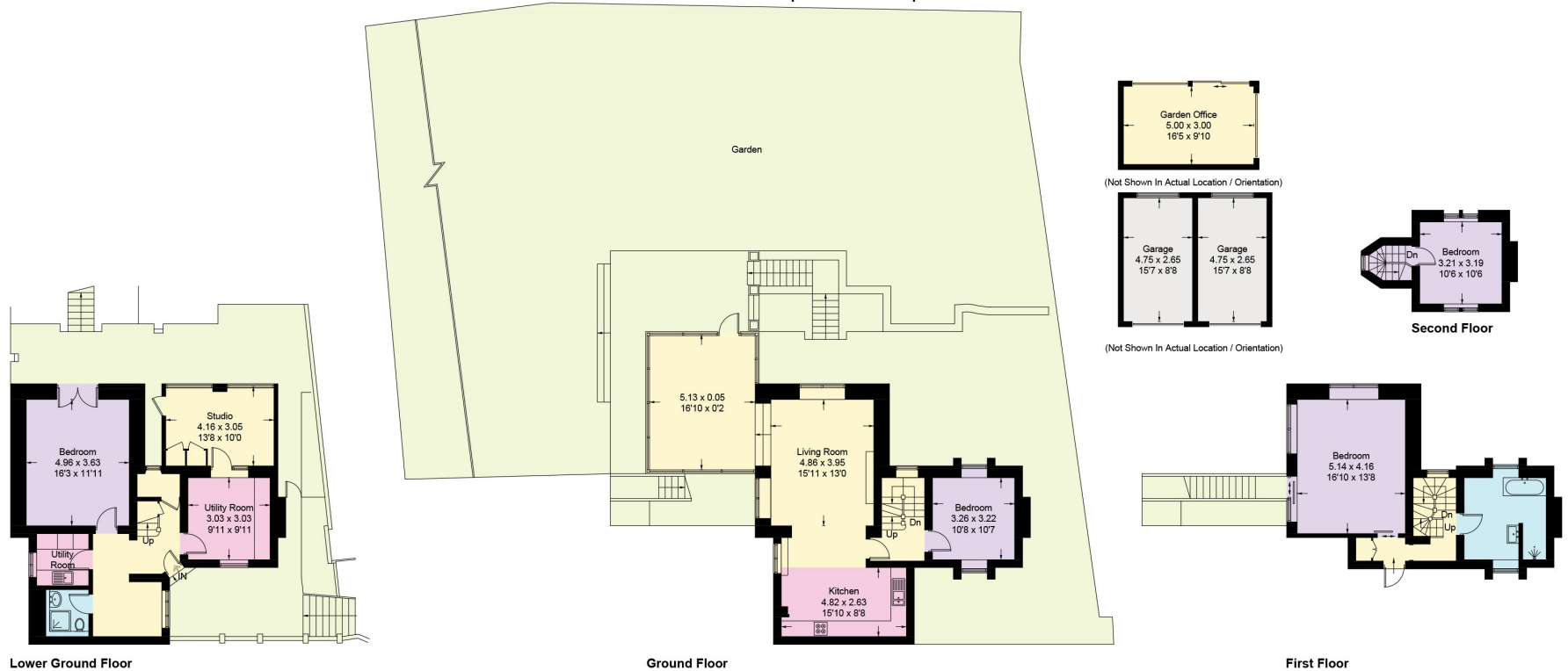

**Knight Frank**  
 Wimbledon  
 58 High Street  
 Wimbledon  
 SW19 5EE  
[knightfrank.co.uk](http://knightfrank.co.uk)

**Lower Ground Floor**  
 We would be delighted to tell you more  
 Dan Kortland                      Danielle Gaughan  
 020 3823 9253                      020 7861 5487  
[daniel.kortland@knightfrank.com](mailto:daniel.kortland@knightfrank.com)    [danielle.gaughan@knightfrank.com](mailto:danielle.gaughan@knightfrank.com)



Fixtures and fittings: A list of the fitted carpets, curtains, light fittings and other items fixed to the property which are included in the sale (or may be available by separate negotiation) will be provided by the Seller's Solicitors.  
 Important Notice: 1. Particulars: These particulars are not an offer or contract, nor part of one. You should not rely on statements by Knight Frank LLP in the particulars or by word of mouth or in writing ("information") as being factually accurate about the property, its condition or its value. Neither Knight Frank LLP nor any joint agent has any authority to make any representations about the property, and accordingly any information given is entirely without responsibility on the part of the agents, seller(s) or lessor(s). 2. Photos, Videos etc: The photographs, property videos and virtual viewings etc. show only certain parts of the property as they appeared at the time they were taken. Areas, measurements and distances given are approximate only. 3. Regulations etc: Any reference to alterations to, or use of, any part of the property does not mean that any necessary planning, building regulations or other consent has been obtained. A buyer or lessee must find out by inspection or in other ways that these matters have been properly dealt with and that all information is correct. 4. VAT: The VAT position relating to the property may change without notice. 5. To find out how we process Personal Data, please refer to our Group Privacy Statement and other notices at <https://www.knightfrank.com/legals/privacy-statement>.  
 Particulars dated September 2024. Photographs and videos dated September 2024.  
 All information is correct at the time of going to print. Knight Frank is the trading name of Knight Frank LLP. Knight Frank LLP is a limited liability partnership registered in England and Wales with registered number OC305934. Our registered office is at 55 Baker Street, London W1U 8AN. We use the term 'partner' to refer to a member of Knight Frank LLP, or an employee or consultant. A list of members names of Knight Frank LLP may be inspected at our registered office. If you do not want us to contact you further about our services then please contact us by either calling 020 3544 0692, email to [marketing.help@knightfrank.com](mailto:marketing.help@knightfrank.com) or post to our UK Residential Marketing Manager at our registered office (above) providing your name and address.