

## Face Mask Guidance

Recent evidence suggests that face coverings can help us protect each other and reduce the spread of the disease from someone who is suffering from coronavirus, but not showing symptoms. Further to the recent information surrounding the new variant and the increased risk of infection we ask that a face covering is worn at all times when moving through landlord / common parts of the building.

The introduction of face mask zones we hope will provide occupiers with reassurance when mixing in areas with other occupiers. The introduction of face mask zones will also allow an increase from 2 to 4 people per lift if all users are wearing a mask. Whilst it is not a legal requirement to wear face masks we do encourage occupiers to comply for the benefit of the building. We understand some occupiers may be exempt due to health related matters.

Signage will be in place to identify the face mask zones.

## Face Mask Area's

- Building Access/Egress points
- Lifts and Lift Lobbies
- Cycle Stores

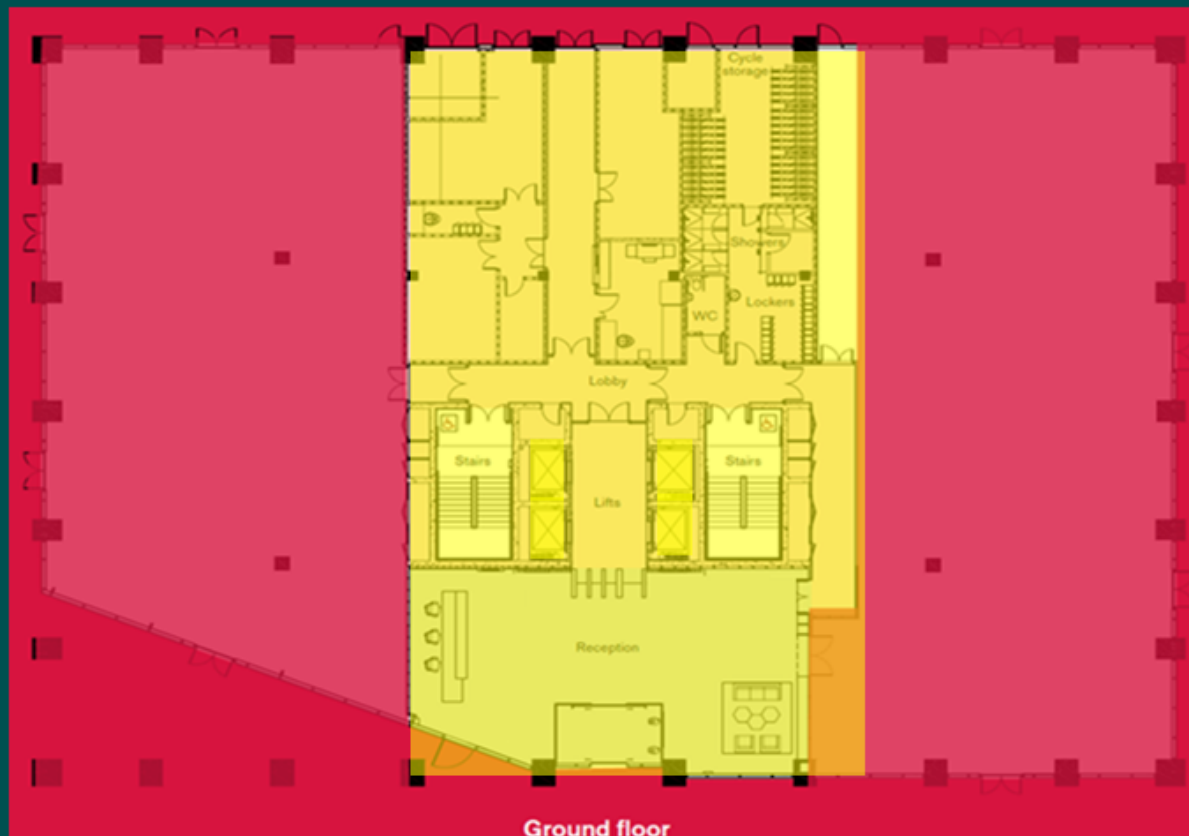

All times

